



# OPIELOK OFFSHORE CARRIERS <sup>GM</sup><sub>BH</sub>

Operators of modern offshore platform supply vessels

**Hydro Patriot** UT755LN DP II Platform supply vessel



# Hydro Patriot

## UT755LN Plattform supply vessel

<b>General</b>		<b>Generators</b>	
Design	- Rolls Royce UT755LN	Shaft generator (Newage)	- Stamford PM734 E2 1280kW 440V 60Hz
Authority / Flag	- Norwegian Maritime Directorate (NOR)	Aux. Generators (Nogva)	- Scania DI 1245M, w/ Stamford generator HCM 434 F 250kW 440V 60Hz
Class (Id no.D26351)	- DNV +1A1- SF- E0 - DK(+) - HL(2,5) - LFL* - DynPos AutR - Clean - Tmon - Comf-V(3)	Emergency Gen. (Nogva)	- John Deere 4045TFM-50, w/ Stamford generator UCM 274F 48kW 440V 60Hz
Optional class notations	- Supply Vessel, FI-FI I, Oil Rec NOFO 2000	<b>Switchboards / consoles and Alarm system</b>	
Ex Ship Name	- ISLAND SPIRIT	Make	- Rolls Royce Automation
Ship Yard:	- Aker Brevik yard. no. 41	Main Switch board	- 1 off Angle 440 / 230 volt divided in two with floating frequency 50-60Hz
Vessel delivered:	- January 2006	Emergency Switch board	- 1 off 440 / 230 volt
IMO Number	- 9350795	Consoles	- one off ECR and four off bridge consoles
		Sounding System	- Rolls Royce Peilo system
		Alarm system	- Rolls Royce UMAS V system acc. To DNV E0
		Pump & Valve control	- Rolls Royce UMAS V system with one operator station in ECR and one on bridge
		<b>Machinery Systems</b>	
		Maintenance system	- Tero Marine (owners delivery) w/50 hour count.
		Fuel & Lub oil Purifiers	- Alfa Laval modul 403SGP-11-60
		Starting air Compressor	- 2 off Sperre HL2/105. 47m <sup>3</sup> /h 30bar 2 off 250l bottles w/ one refr. air drier
		Working/Instrument air compr.	- Kaeser SX6, 500l/h 7,5bar
		Cooling systems	- A sea water cooled LT.fresh water system with el. Pumps feeding a HT jacket water system with mech. Pumps. The systems is divided in two acc. To DNV AutR. w/ PID controlled 3-way valves SW.pumps are frequency controlled
<b>Main Particulars</b>		<b>Deck Machinery</b>	
Lenght overall	- 73,60 m	Windlass (RR.Brattvåg)	- 38mm K3 8 tonnes 0-10,5 m/min, 33bar
Lenght betw. Perpend.	- 68,30 m	Tugger winch (RR.Brattvåg)	- 2 off 10 ton at 0-19m/min, 60bar
Bredth moulded	- 16,00 m	Capstans (RR.Brattvåg)	- 2 off 8 tonnes at 0-16m/min 55bar
Depth moulded	- 7,00 m	Deck Crane (ABAS)	- 3t at 16m Knuckle boom
Max draft midship	- Approx. 5,80 m		
Speed at 4,0 m	- Approx. 14,7 knots		
Fuel Consumption pr engine	- 80% - 265 l/h and 100% 480l/h		
Gross tonnage	- Approx. 2265 GRT		
Net tonnage	- Approx. 1120 NT		
Deadweight at 5,9 m	- Approx. 3195 tonnes		
Lightship weight	- Approx. 1780 tonnes		
		<b>Anti rolling system</b>	
<b>Cargo capacities</b> (approx.)			
Free deck area	- 660 m <sup>2</sup>		
Deck Cargo Capacity	- 1600 tonnes		
Fresh Water	- 657 m <sup>3</sup>		
Fuel Oil	- 1000 m <sup>3</sup>		
Ballast / Drillwater	- 1300 m <sup>3</sup>		
Liquid Mud	- 980 m <sup>3</sup>		
Brine	- 390 m <sup>3</sup>		
Base oil	- 200 m <sup>3</sup>		
Methanol	- 140 m <sup>3</sup>		
Dry Bulk (Cement)	- 5 tanks with totaly 315 m <sup>3</sup>		
		<b>Fire fighting Syst. / Equip.</b>	
<b>Pumps with Discharge rates</b>		Loose fire fighting equipment	- Erling Haug
Make pump package	- Per Gjerdrum AS	Total flooding fire system	- Unitor CO <sub>2</sub> system
Fresh Water	- 200 m <sup>3</sup> /h at 9bar 2-speed Centr.	Local hi-risk fire fighting system	- Unitor local hirisk fire-fighting system
Fuel Oil	- 200 m <sup>3</sup> /h at 9bar 2-speed Centr.	Galley frying pan fire fight.system	- Beha Hedo Ansul system (Potassium Carbonate)
Ballast / Drillwater	- 200 m <sup>3</sup> /h at 9bar 2-speed Centr.	Nitrogen system for Methanol	- Unitor Nitrogen system w/ Generator
Liquid Mud	- 2x75 m <sup>3</sup> /h at 18bar frequency contr. Ecc. screw	Foam system for Methanol	- Unitor Foam system for aft Main deck.
Brine	- 75 m <sup>3</sup> /h at 18bar 2-speed Ecc. screw	External FI-FI system	- Option (Kværner Eureka)
Base oil	- 150 m <sup>3</sup> /h at 9bar 2-speed Centr.		
Methanol	- 2x80m <sup>3</sup> /h at 90m subm. hydr. driven Centr.		
Hydraulic Powerpack	- 0-166l/min 260bar, 2 hydr. pumps		
Dry Bulk (RR:Brattvåg)	- 2x25,6 m <sup>3</sup> /min at 5,6 bar Tamrotor 132-6 compr. with cyclone and refr. Air driers		
		<b>Lifesaving equipment</b>	
			- 4 off 25 persons Viking liferafts
<b>Cargo systems description</b>		<b>Rescue boat with davit</b>	
	- 5" systems with VECO fig. 50 couplings		- One off Midget Mk2 5,02m , 25Hk outboard with one TTS HL 9D-A Davit 1,5 ton
	Ballast and fuel oil transferable betw. groups of tanks. Fresh W. transferable between fore and aft ship. Mud and Brine systems to have recirculation piping and agitator in the 6 aftermost tanks		
	All systems to be remote operated by UMAS		
	Fuel oil to have flowmeter for measuring when loading, discharging and transferring to domestic tanks		
<b>Cargo discharge stations</b>		<b>Accommodation</b>	
Port & Starboard amidship	- FO, FW, BO, DW, Cement I+II, Mud I+II & Brine	Accommodation make	- Maritime Montering AS
Starboard Aft	- BO, DW, Cement I, Mud II & Methanol	Number of person	- 12 crew & 16 Pax Optional one 4 double cabins and Treatment room
Port Aft	- FO, FW, Cement II, Mud I & Brine		
Tankwashing System	- Option		
		Ventilation	- Aeron / Teknotherm Summer: in 27 50%hum.- out 35 80%hum. Vinter: in 20 - out -20 One off 100% main Teknotherm AC Compr. One 10 kw ECR AC unit & 14kW Bridge AC unit All compressors are watercooled
<b>Propulsion/ Machinery</b>		Mess Equipment	- Beha Hedo
Main Engines (RR.Bergen)	- KRMB 9, 2005 kW (2725 BHP) 825rpm	Hotwater boiler	- Pyro E1120, 123kW, 1x10kW el.heater
Reduction Gears (RR.Propulsion)	- 600 AGSC-KP500ND 825/197rpm	Sewage treatment plant	- DVZ SKA 20 unit with Jets 30MB pumps
Propellers (RR.Propulsion)	- 66P1/4T, 4 blades 2900mm	Sanitary system	- A jets / Brønsten vacuum system
Steering gears (RR.Tennfjord)	- SR622-FCP 70kNm independent oper.	Provision cooling	- Nilsen Frys og Kjøleteknikk
Rudders (RR.Brattvåg)	- HLR-S 1750 Flap type rudders		
Bow Thrusters (RR.Propulsion)	- 2 off TT1850DPN 590kW 1180/250rpm		
Stem Thruster (RR.Propulsion)	- 2 off TT1650DPN 590kW 1180/312rpm All thruster motors are watercooled	<b>Navigation/ Communication equipment</b>	
Joystick (RR.Propulsion)	- PosCon w/ 1 portable panel	(Supplier - Basse Gundersen)	- 2x21" Furuno radars, 3 Simrad gyro, DGPS, Echo-sounder, autopilot, windsensor, speed log, Radio-plant, VHF/UHF, fleet 77, AIS, EPIRB, Radar trans.
		Satelite TV antenna	- Shipequip Model 5004E
		Satelite Data antenna	- Shipequip SevSat 4003
		<b>Dyn. Positioning system</b>	
			- Marine Technologies DP11 system prepared for HPR.
		<b>Fuel Consumption</b>	
		Economical 9 Kn Speed .	8 m <sup>3</sup> /day
		Standing by on location in DP / 24 Hrs	6-8 m <sup>3</sup> / day

# UT-design UT 755 LN

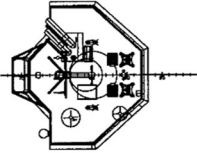
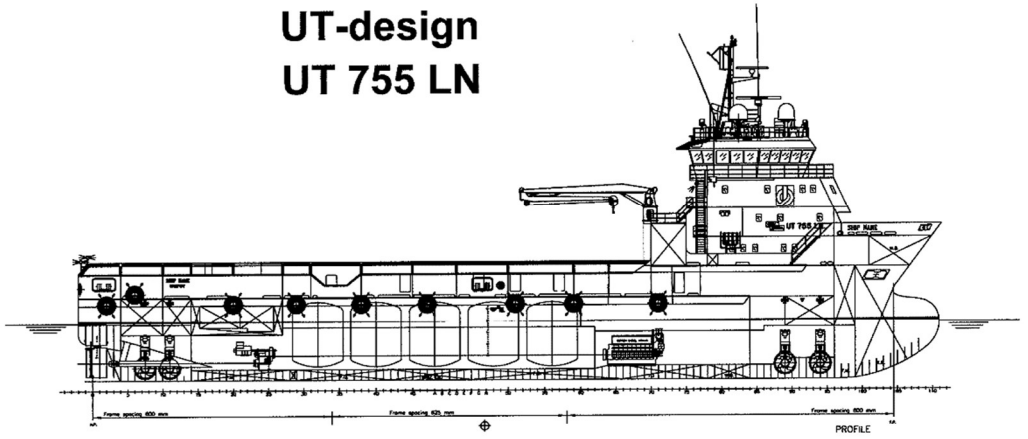

TOP WHEELHOUSE

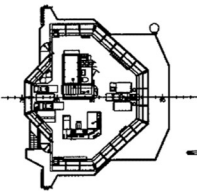

BRIDGE DECK

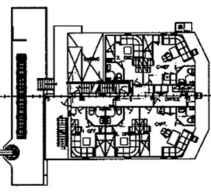

B-DECK

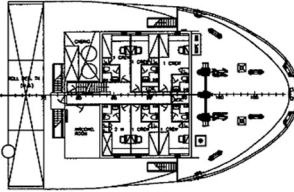

A-DECK

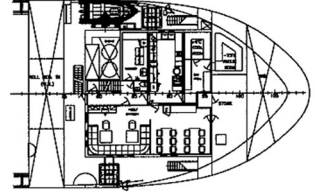

FORECASTLE DECK

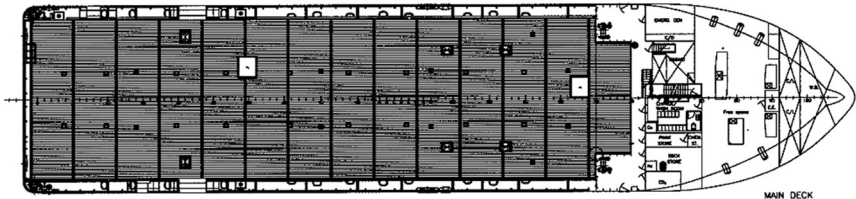

MAIN DECK

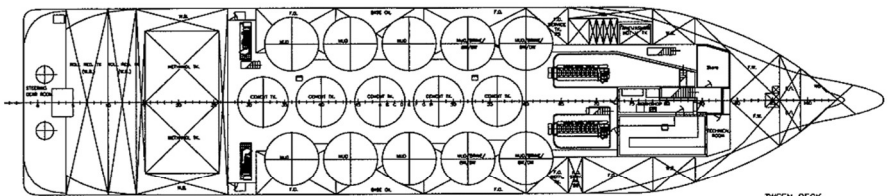

TWEEN DECK

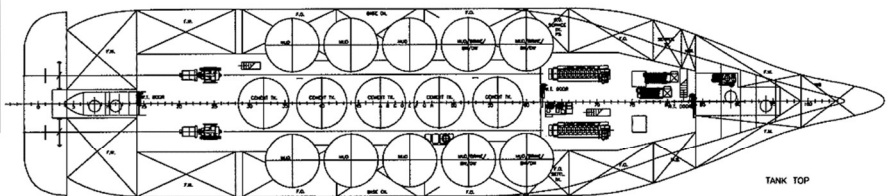

TANK TOP

TYPE: UT 755 LN

**MAIN PARTICULARS**

L.O.A. .... APPROX. 73.60 m  
 L.P.P. .... 68.30 m  
 BREADTH M.D. .... 16.00 m  
 DEPTH MAIN DK. .... 7.00 m  
 DESIGN DRAFT. .... 5.00 m  
 MAX DRAFT. .... APPROX. 5.90 m

A	14.03.03	ISSUED FOR CONTRACT (PARTIAL) NO. 8 5148 TR (1/0)	SP	07	45
0	12.01.03	FOR PRODUCTION	SP	07	45
1	02.12.04	FOR IMPROVEMENT	SP	07	45
REV	DATE	REVISION	SP	07	45
<b>Bevlik Engineering</b> 41 70411100 104-1-41001 A		Sheet no. 01 Project no. 104-1-41001 A	Date: 01.01.05 Scale: 1:200	Drawing No. 104-1-41001 A	Date: 01.01.05
<b>Rolls-Royce</b> UT-design UT 755 LN GENERAL ARRANGEMENT					